

Motor M700

## M700

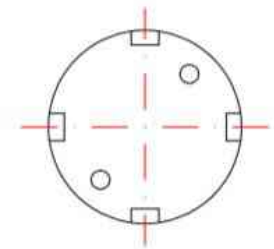
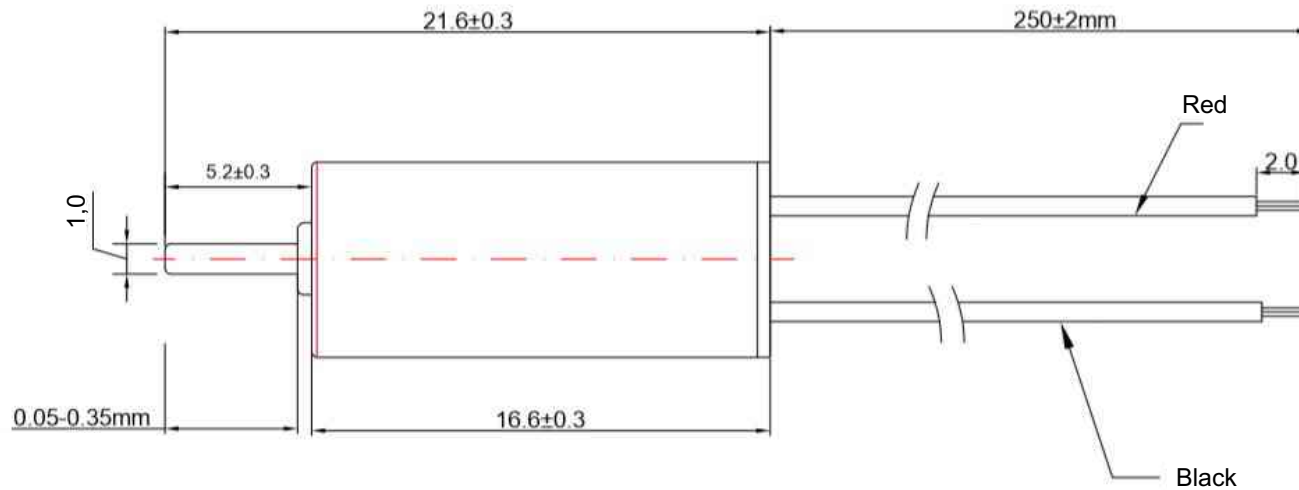
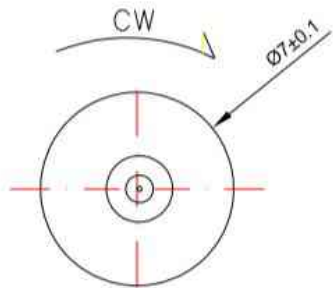

### TECHNICAL SPECIFICATIONS

Rated voltage	3.7 volts
Starting current max.	120 mA
Operating voltage	0.5 - 4 volts
No load speed	40000 ± 3000
Internal resistance	2.4 ohms ± 20%
Direction of rotation	clockwise
Working temperature	(-20 ° C) to (+ 60 ° C)
Axial end play	0.05 - 0.3 mm
Weight	2.6 grams ± 10%
Cable length	250 mm
Cable colors	red = plus, black = minus



Art.No.: 01247



4 037373 012473